

24m Support Vessel

SV24

24m multi-purpose Support Vessel

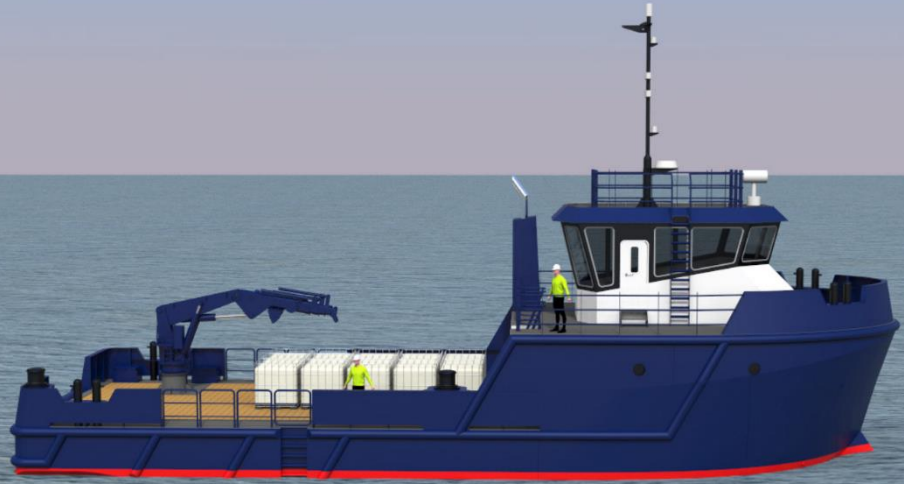

A 24m Steel Multi Role Support Vessel

Aquaculture Support – Survey – Offshore maintenance – Logistical / Dive support



PDL Marine are proud to present the 24m Multi purpose Support Vessel.

A wide array of options are available for this vessel depending on its use, twin cranes can be fitted, large hydraulic A frame, large winches and capstans. This vessel is suitable for a multitude of tasks such as Aquaculture support, Survey work, Offshore maintenance and Dive support to name but a few.

The vessel can also be fitted with wet rooms and laboratories and additional accommodation if required.

Fitted with twin Doosan V180TIH engines helping to push the vessel to 10 knots, other engines are available if required.

The vessel is built to MCA category 1/2 standards and can also be built to class.

Other equipment includes but not limited to:

Deck winches

Capstans

20T Hydraulic A Frame

Laboratories and wet rooms



24m Support Vessel

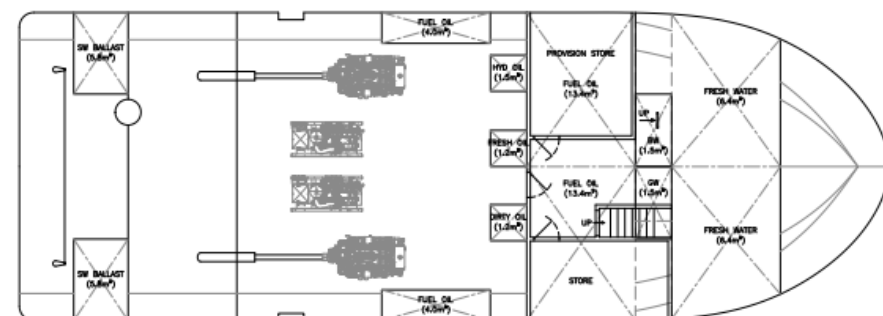
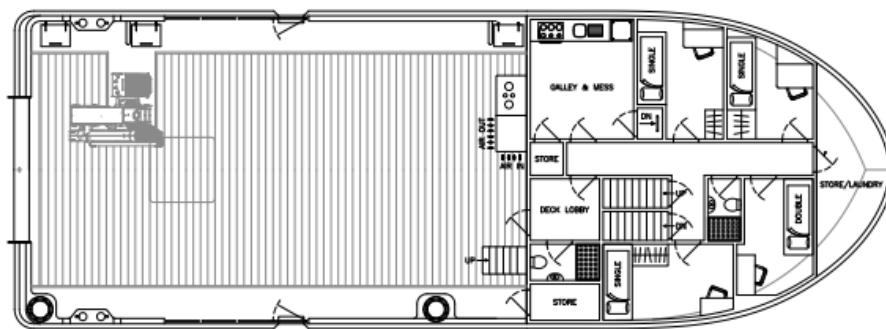
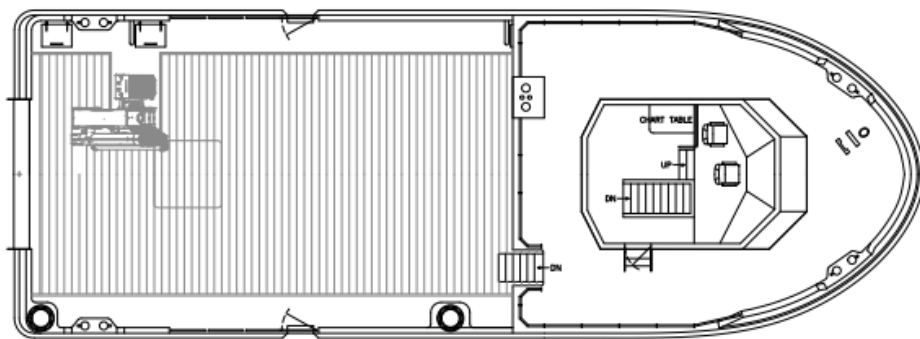
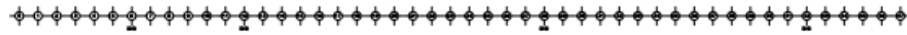
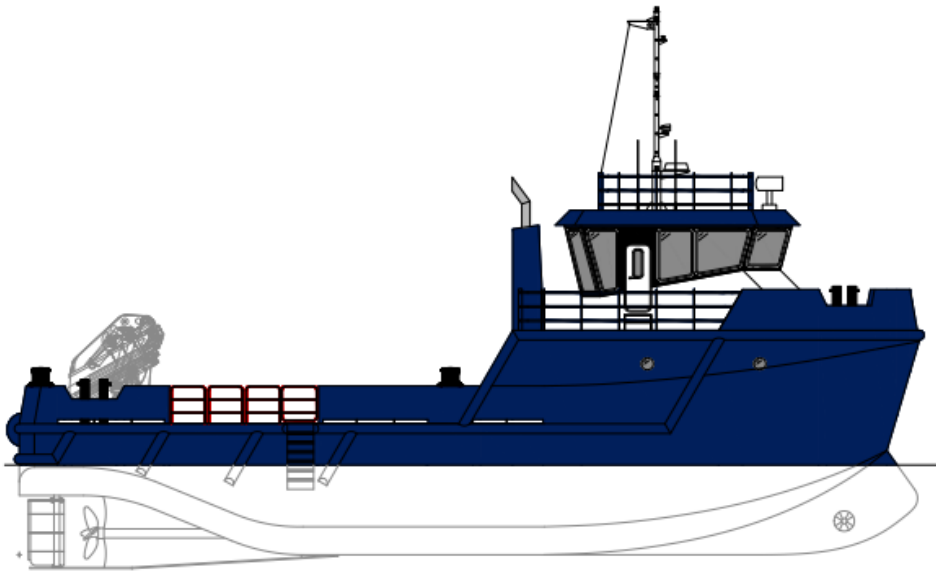

Length Hull	22.9 m
Length Waterline	23.41 m
Length Overall	24.46 m
Beam Hull	8.50 m
Draft	2.77 m

Power Twin Doosan V180TIH (other engines available)

Service Speed	8 Knots
Maximum Speed	10 Knots

Fuel Oil	34,800 Litres
Fresh Water	12,800 Litres
Black Water	3000 Litres
Deck Cargo	75 Tonnes
Crew	3
Passengers	12 in Survey Role

Deck Crane Hydraulic Knuckle-Boom (up to 2)

A Frame 20 Ton hydraulic

Capstans x4

Additional holding tanks available

Wet Rooms